









ERGOPLUS 24

CE EN60974-7

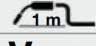

CODE	↔			
MA7143	3 m	10'		1
MA7144	4 m	12'		1
MA7145	5 m	16.4'		1

CODE	↔			
MA7194	3 m	10'		25
MA7195	4 m	12'		25
MA7196	5 m	16.4'		25

TECHNICAL DATA		
ERGOPLUS 24		
	1,2 kg	2.76 lb
	113	
V PEAK		
	0,6 ÷ 1,2 mm	.30" - .045"
X 60%	250A CO2 - 220A Mix	

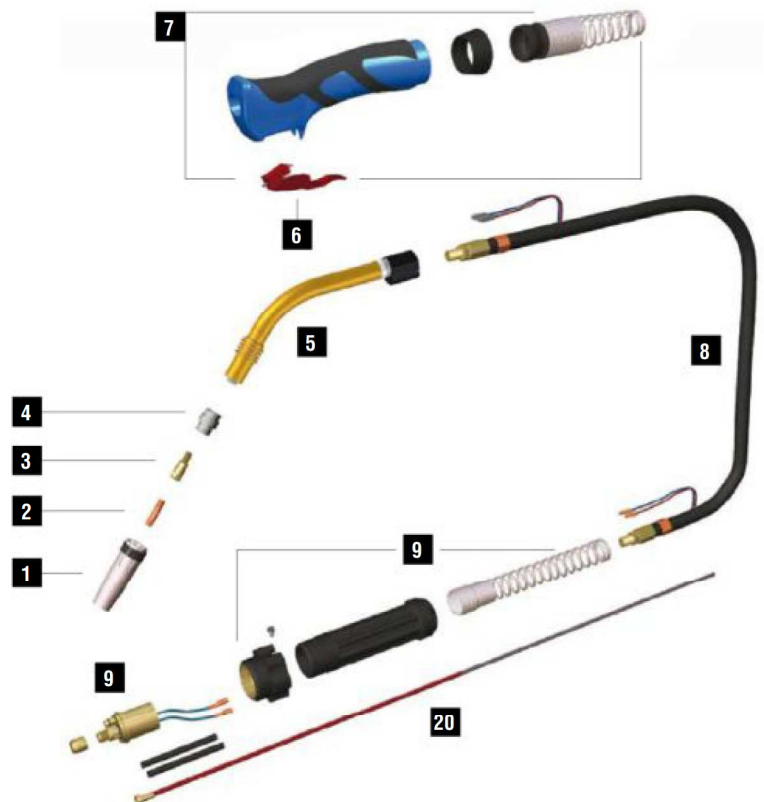

	CODE			Ø		↔	REF		
1	MC0300		nozzle	17 mm	21/32"	63,5 mm	2-1/2"	145.0062	10
1	MC0301		nozzle	12,5 mm	1/2"	63,5 mm	2-1/2"	145.0080	10
1	MC0302		nozzle	10 mm	13/32"	63,5 mm	2-1/2"	145.0128	10
1	MC0303		nozzle	17 mm	21/32"	68 mm	2-11/16"	145.0174	10
2	MD0008-06		M6 - Cu	0,6 mm	.023"	25 mm	31/32"	140.0008	20
2	MD0008-08		M6 - Cu	0,8 mm	.030"	25 mm	31/32"	140.0059	20
2	MD0008-09		M6 - Cu	0,9 mm	.035"	25 mm	31/32"	140.0177	20
2	MD0008-10		M6 - Cu	1,0 mm	.040"	25 mm	31/32"	140.0253	20
2	MD0008-12		M6 - Cu	1,2 mm	.045"	25 mm	31/32"	140.0387	20
3	MD0138-00		M6 - brass			26 mm	1" 1/32	142.0003	10
4	ME0084		plastic			20 mm	25/32"	012.0183	10
4	ME0086		silicon			20 mm	25/32"	-	10
4	ME0484		plastic compound high tech			20 mm	25/32"	-	10
4	ME0584		ceramic			20 mm	25/32"	-	10
20	GM0510		red steel liner	1,0 ÷ 1,2 mm	.040" ÷ .045"	3 m	10'	124.0026	1
20	GM0511		red steel liner	1,0 ÷ 1,2 mm	.040" ÷ .045"	4 m	12'	124.0031	1
20	GM0512		red steel liner	1,0 ÷ 1,2 mm	.040" ÷ .045"	5 m	16.4'	124.0035	1

	CODE			
5	MF0180		Ergoplus 24 torch head	1
6	BX0024		trigger	5
7	MT0237		handle kit	1
8	MH0119		coaxial cable - 3 m / 10'	1
8	MH0124		coaxial cable - 4 m / 12'	1

	CODE			
8	MH0125		coaxial cable - 5 m / 16.4'	1
9	AR0070		EURO connector - air	1
9	BW0020		metal EURO nut	10
9	FA0026		liner nut M10x1	10
9	MT0229		Back box kit EURO	1

STANDARD

FOR ALL WEAR PARTS SEE PAGE 276