

# TPRO 26

CE EN60974-7



CODE	↔			
HK2407-00	4 m	12.5'	dual	TSK 50-1/4G
HK2807-00	8 m	25'	dual	
HL2407-00	4 m	12.5'	dual flex	
HL2807-00	8 m	25'	dual flex	

TECHNICAL DATA		
<b>TPRO 26</b>		
	0,80 kg	1.76 lb
	113	
<b>PEAK</b>	Argon	
	0,5 ÷ 4,0 mm	.020" ÷ 5/32"
<b>X 35%</b>	180A DC - 150A AC	

CODE		Description	Quantity
4		insulator	10
5		tig 26 torch head	1
6		tig 26 flex torch head	1
7		back cap 117 mm	10
7		O-ring Ø 9x2 mm	10
8		kit Tpro Dual	1
9		kit Tpro Multi	1
10		cable joint	1
10		screw	50
10		Tpro handle	1
11		cable assembly - 4 m / 12.5'	1
11		cable assembly - 8 m / 25'	1
12		power cable - 4 m / 12.5'	1
12		power cable - 8 m / 25'	1
15		TSK 50 - 1/4 G plug	1

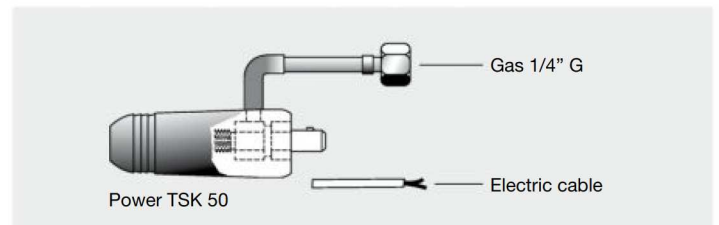
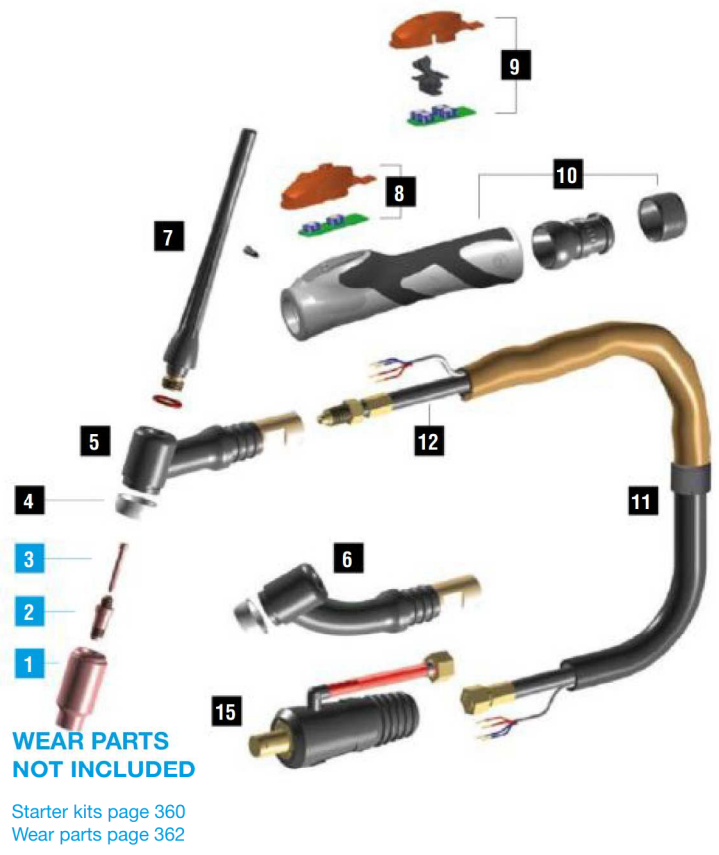

# TIG TORCH HEADS



## MANUAL

CODE			
TF0009		TIG 9	1
TF0010		TIG 9 FLEX	1
TF0222		TIG 9 FLEX 100 mm	1
TF0017		TIG 17	1
TF0022		TIG 17 FLEX	1
TF0024		TIG 24	1
TF0224		TIG 24 FLEX	1
TF0026		TIG 26	1
TF0027		TIG 26 FLEX	1

## VALVE

CODE			
TF0109		TIG 9 V	1
TF0110		TIG 9 V FLEX	1
TF0117		TIG 17 V	1
TF0118		TIG 17 V FLEX	1
TF0126		TIG 26 V	1
TF0127		TIG 26 V FLEX	1

## AUTOMATIC

CODE			
TF1000		AUTOTIG 9	1
TF1001		AUTOTIG 26	1



## FLEXLOCK

CODE			
TF0072		FLEXLOCK 17 - 18	1
TF0071		FLEXLOCK 9 - 20	1
TF0070		FLEXLOCK 9 - 17	1
BW0535		fixing screw FLEXLOCK 9 - 17 - 18 - 20	1

## MANUAL

CODE			
TG0018		TIG 18	1
TG0118		TIG 18 FLEX	1
TG0913		TIG 18 HC	1
TG0914		TIG 18 HC FLEX	1
TG0020		TIG 20	1
TG0220		TIG 20 FLEX	1
TG0223		TIG 20 FLEX 125 mm	1
TG0912		TIG 20 HC	1
TG0911		TIG 20 HC FLEX	1
TG0024		TIG 24W	1
TG0224		TIG 24W FLEX	1
TG0025		TIG 25	1
TG0917		SUPER 50	1

## AUTOMATIC

CODE			
TG1001		AUTOTIG 18	1
TG1000		AUTOTIG 20	1

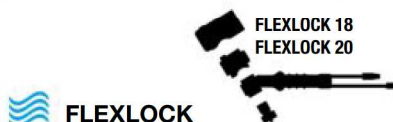

## FLEXLOCK

CODE			
TF0072		FLEXLOCK 17 - 18	1
TF0071		FLEXLOCK 9 - 20	1
TG0070		FLEXLOCK 18 - 20	1
BW0535		fixing screw FLEXLOCK 9 - 17 - 18 - 20	1

# TUNGSTEN ELECTRODES

UNI EN ISO 6848-2004



CODE		$\varnothing$	$\longleftrightarrow$	
TR0001-10		1 mm	150 mm	1
TR0001-16		1,6 mm	150 mm	1
TR0001-20	<b>WP</b>	2 mm	150 mm	1
TR0001-24		2,4 mm	150 mm	1
TR0001-32		3,2 mm	150 mm	1
TR0001-40		4 mm	150 mm	1
TR0001-48		4,8 mm	150 mm	1
TR0002-10	<b>WP</b>	1 mm	175 mm	1
TR0002-16		1,6 mm	175 mm	1
TR0002-20		2 mm	175 mm	1
TR0002-24		2,4 mm	175 mm	1
TR0002-32		3,2 mm	175 mm	1
TR0002-40		4 mm	175 mm	1
TR0002-48		4,8 mm	175 mm	1
TR0002-64		6,4 mm	175 mm	1
TR0007-10	<b>WC20</b>	1 mm	150 mm	1
TR0007-16		1,6 mm	150 mm	1
TR0007-20		2 mm	150 mm	1
TR0007-24		2,4 mm	150 mm	1
TR0007-32		3,2 mm	150 mm	1
TR0007-40		4 mm	150 mm	1
TR0007-48		4,8 mm	150 mm	1
TR0008-10	<b>WC20</b>	1 mm	175 mm	1
TR0008-16		1,6 mm	175 mm	1
TR0008-20		2 mm	175 mm	1
TR0008-24		2,4 mm	175 mm	1
TR0008-32		3,2 mm	175 mm	1
TR0008-40		4 mm	175 mm	1
TR0008-48		4,8 mm	175 mm	1
TR0011-10	<b>WL10</b>	1 mm	150 mm	1
TR0011-16		1,6 mm	150 mm	1
TR0011-20		2 mm	150 mm	1
TR0011-24		2,4 mm	150 mm	1
TR0011-32		3,2 mm	150 mm	1
TR0011-40		4 mm	150 mm	1
TR0011-48		4,8 mm	150 mm	1
TR0012-16	<b>WL10</b>	1,6 mm	175 mm	1
TR0012-24		2,4 mm	175 mm	1
TR0012-32		3,2 mm	175 mm	1

CODE		$\varnothing$	$\longleftrightarrow$	
TR0013-10	<b>WL15</b>	1 mm	150 mm	1
TR0013-16		1,6 mm	150 mm	1
TR0013-20		2 mm	150 mm	1
TR0013-24		2,4 mm	150 mm	1
TR0013-32		3,2 mm	150 mm	1
TR0013-40		4 mm	150 mm	1
TR0013-48		4,8 mm	150 mm	1
TR0014-10	<b>WL15</b>	1 mm	175 mm	1
TR0014-16		1,6 mm	175 mm	1
TR0014-20		2 mm	175 mm	1
TR0014-24		2,4 mm	175 mm	1
TR0014-32		3,2 mm	175 mm	1
TR0014-40		4 mm	175 mm	1
TR0014-48		4,8 mm	175 mm	1
TR0017-10	<b>WL20</b>	1 mm	150 mm	1
TR0017-16		1,6 mm	150 mm	1
TR0017-20		2 mm	150 mm	1
TR0017-24		2,4 mm	150 mm	1
TR0017-32		3,2 mm	150 mm	1
TR0017-40		4 mm	150 mm	1
TR0017-48		4,8 mm	150 mm	1
TR0018-10	<b>WL20</b>	1 mm	175 mm	1
TR0018-16		1,6 mm	175 mm	1
TR0018-20		2 mm	175 mm	1
TR0018-24		2,4 mm	175 mm	1
TR0018-32		3,2 mm	175 mm	1
TR0018-40		4 mm	175 mm	1
TR0021-10	<b>WR2</b>	1 mm	150 mm	1
TR0021-16		1,6 mm	150 mm	1
TR0021-20		2 mm	150 mm	1
TR0021-24		2,4 mm	150 mm	1
TR0021-32		3,2 mm	150 mm	1
TR0021-40		4 mm	150 mm	1
TR0021-48		4,8 mm	150 mm	1
TR0022-10	<b>WR2</b>	1 mm	175 mm	1
TR0022-16		1,6 mm	175 mm	1
TR0022-20		2 mm	175 mm	1
TR0022-24		2,4 mm	175 mm	1
TR0022-32		3,2 mm	175 mm	1
TR0022-40		4 mm	175 mm	1

## WEAR PARTS KITS



## STARTER KITS



## 9 - 20 - 20 HC - 25

CODE	Ø			
TT0101	1,6 mm	1/16"	WR2	1
TT0102	2,4 mm	3/32"	WR2	1

## 17 - 18 - 18 HC - 26

CODE	Ø			
TT0103	1,6 mm	1/16"	WR2	1
TT0104	2,4 mm	3/32"	WR2	1
TT0105	3,2 mm	1/8"	WR2	1

## 24 - 24W

CODE	Ø			
TT0203	1,6 mm	1/16"	WC20	1
TT0204	2,4 mm	3/32"	WC20	1

## STARTER KITS



## 9 - 20 - 20 HC - 25

CODE	Ø			
TT0221	1,6 mm	1/16"		1
TT0222	2,4 mm	3/32"		1

## 17 - 18 - 18 HC - 26

CODE	Ø			
TT0223	1,6 mm	1/16"		1
TT0224	2,4 mm	3/32"		1

## 24 - 24W

CODE	Ø			
TT0226	1,6 mm	1/16"		1

## MASTER KITS



## 9 - 20 - 20 HC - 25

CODE	Ø		
TT0109	1,0 mm - 1,6 mm - 2,0 mm - 2,4 mm - 3,2 mm		1

## 17 - 18 - 18 HC - 26

CODE	Ø		
TT0110	1,6 mm - 2,0 mm - 2,4 mm - 3,2 mm - 4,0 mm		1

## STARTER KITS WITH BACK CAP



## 9 - 20 - 20 HC - 25

CODE	Ø			
TT0021	1,6 mm	1/16"	WC20	1
TT0022	2,4 mm	3/32"	WC20	1

## 17 - 18 - 18 HC - 26

CODE	Ø			
TT0023	1,6 mm	1/16"	WC20	1
TT0024	2,4 mm	3/32"	WC20	1
TT0025	3,2 mm	1/8"	WC20	1

# SERIES 17 - 18 - 26 - SUPER 18 WEAR PARTS

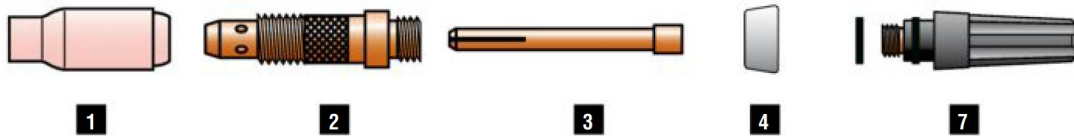

## STANDARD

	CODE		Gr	Ø	↔	REF	
1	TC0002		4	6,4 mm 1/4"	47 mm	10N50	10
1	TC0003		5	8 mm 5/16"	47 mm	10N49	10
1	TC0004		6	9,8 mm 3/8"	47 mm	10N48	10
1	TC0005		7	11,2 mm 7/16"	47 mm	10N47	10
1	TC0006		8	12,7 mm 1/2"	47 mm	10N46	10
1	TC0007		10	15,7 mm 5/8"	47 mm	10N45	10
1	TC0008		12	19 mm 3/4"	47 mm	10N44	10
1	TC0091		5	8 mm 5/16"	76 mm	10N49L	10
1	TC0092		6	9,5 mm 3/8"	76 mm	10N48L	10
1	TC0093		7	11 mm	76 mm	10N47L	10
2	TE0001-05			0,5 mm .020"	47 mm	10N29	10
2	TE0001-10			1,0 mm .040"	47 mm	10N30	10
2	TE0001-16			1,6 mm 1/16"	47 mm	10N31	10
2	TE0001-20			2,0 mm 5/64"	47 mm	-	10
2	TE0001-24			2,4 mm 3/32"	47 mm	10N32	10
2	TE0001-32			3,2 mm 1/8"	47 mm	10N28	10
2	TE0001-40			4,0 mm 5/32"	47 mm	406488	10
2	TE0001-48			4,8 mm 3/16"	47 mm	30126	10

	CODE		Gr	Ø	↔	REF	
3	TD0001-05			0,5 mm .020"	50 mm	10N21	10
3	TD0001-10			1,0 mm .040"	50 mm	10N22	10
3	TD0001-16			1,6 mm 1/16"	50 mm	10N23	10
3	TD0001-20			2,0 mm 5/64"	50 mm	-	10
3	TD0001-24			2,4 mm 3/32"	50 mm	10N24	10
3	TD0001-32			3,2 mm 1/8"	50 mm	10N25	10
3	TD0001-40			4,0 mm 5/32"	50 mm	54N20	10
3	TD0001-48			4,8 mm 3/16"	50 mm	30028	10
4	TQ0002					18CG	10
4	TQ0008 *					-	10
7	BW0056				58 mm	57Y03	10
7	BW0066				117 mm	57Y02	10
7	BW0067				22,5 mm	57Y04	10
7	EA0130						10

\* ONLY FOR 18 HC

## GAS LENS

	CODE		Gr	Ø	↔	REF	
1	TC0031		4	6,4 mm 1/4"	42 mm	54N18	10
1	TC0032		5	8 mm 5/16"	42 mm	54N17	10
1	TC0033		6	9,8 mm 3/8"	42 mm	54N16	10
1	TC0034		7	11,2 mm 7/16"	42 mm	54N15	10
1	TC0035		8	12,7 mm 1/2"	42 mm	54N14	10
1	TC0036		11	19 mm 3/4"	42 mm	53N87	10
1	TC0037			17,2 mm	28,6 mm	54N19	10
1	TC0086		5	8 mm 5/16"	76 mm	54N17L	10
1	TC0087		6	9,5 mm 3/8"	76 mm	54N16L	10
1	TC0088		7	11 mm	76 mm	54N15L	10
2	TE0006-05			0,5 mm .020"	50 mm	45V29	10
2	TE0006-10			1,0 mm .040"	50 mm	45V24	10
2	TE0006-16			1,6 mm 1/16"	50 mm	45V25	10
2	TE0006-20			2,0 mm 5/64"	50 mm	-	10
2	TE0006-24	Cu + CuZn		2,4 mm 3/32"	50 mm	45V26	10
2	TE0006-32			3,2 mm 1/8"	50 mm	45V27	10
2	TE0006-40			4,0 mm 5/32"	50 mm	45V28	10
3	TD0022-10			1,0 mm .040"	52 mm	-	10
3	TD0022-16			1,6 mm 1/16"	52 mm	-	10
3	TD0022-24			2,4 mm 3/32"	52 mm	-	10
3	TD0022-32			3,2 mm 1/8"	52 mm	-	10
3	TD0022-40			4,0 mm 5/32"	52 mm	-	10
4	TQ0003					54N01	10
7	BW0056				58 mm	57Y03	10
7	BW0066				117 mm	57Y02	10
7	BW0067				22,5 mm	57Y04	10
7	EA0130						10

## GAS LENS XL (JUMBO)

	CODE		Gr	Ø	↔	REF	
1	TC0118		8	12,7 mm 1/2"	48 mm	57N74	10
1	TC0119		10	15,7 mm 5/8"	48 mm	53N88	10
1	TC0120		12	19,5 mm 3/4"	48 mm	53N87	10
2	TE0009-16			1,6 mm 1/16"	51 mm	45V16	2
2	TE0009-24			2,4 mm 3/32"	51 mm	45V64	2
2	TE0009-32			3,2 mm 1/8"	51 mm	995795	2
2	TE0009-40			4,0 mm 5/32"	51 mm	45V63	2
3	TD0001-05			0,5 mm .020"	50 mm	10N21	10
3	TD0001-10			1,0 mm .040"	50 mm	10N22	10
3	TD0001-16			1,6 mm 1/16"	50 mm	10N23	10
3	TD0001-20			2,0 mm 5/64"	50 mm	-	10
3	TD0001-24			2,4 mm 3/32"	50 mm	10N24	10
3	TD0001-32			3,2 mm 1/8"	50 mm	10N25	10
3	TD0001-40			4,0 mm 5/32"	50 mm	54N20	10
3	TD0001-48			4,8 mm 3/16"	50 mm	30028	10
4	TQ0027					54N63	10
7	BW0056				58 mm	57Y03	10
7	BW0066				117 mm	57Y02	10
7	BW0067				22,5 mm	57Y04	10
7	EA0130						10

Gas protection flow is usually guttered by a STANDARD ceramic nozzle (picture 1). Such flow is affected by turbulences of head torch which are caused by the inlet pressure. In order to assure a uniform gas distribution, above all in stainless steel, titanium and aluminium alloys welding, we suggest the use of GAS LENS spare parts. The electrode holder equipped with a gas lens net, uniform the flow (picture 2) and aid to save the protection gas. Where permitted by external dimensions, it is recommended the JUMBO version which increases the protected surface with advantage for welding quality (picture 3).

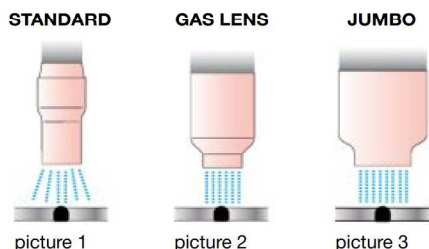

# SERIES 17 - 18 - 26 - SUPER 18 STUBBY WEAR PARTS

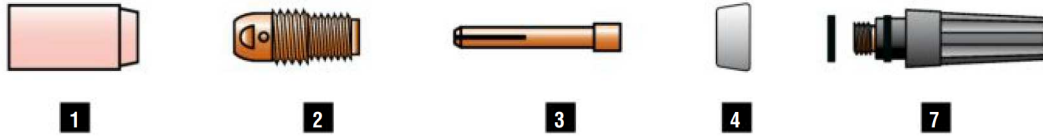

## STUBBY

	CODE		Gr	Ø		REF	
1	TC0012		4	6,4 mm 1/4"	30 mm	13N08	10
1	TC0013		5	8 mm 5/16"	30 mm	13N09	10
1	TC0014		6	9,8 mm 3/8"	30 mm	13N10	10
1	TC0015		7	11,2 mm 7/16"	30 mm	13N11	10
1	TC0016		8	12,7 mm 1/2"	30 mm	13N12	10
1	TC0017		10	15,7 mm 5/8"	30 mm	13N13	10
1	TC0096		4	6,5 mm 1/4"	48 mm	796F71	10
1	TC0097		5	8 mm 5/16"	48 mm	796F72	10
1	TC0098		6	9,5 mm 3/8"	48 mm	796F73	10
1	TC0101		4	6,5 mm 1/4"	63 mm	796F75	10
1	TC0102		5	8 mm 5/16"	63 mm	796F76	10
1	TC0103		4	6,5 mm 1/4"	89 mm	796F79	10
2	TE0002-00			1,0 mm .040"	24,5 mm	17CB20	10
3	TD0002-10			1,0 mm .040"	29 mm	10N22S	10
3	TD0002-16			1,6 mm 1/16"	29 mm	10N23S	10
3	TD0002-20			2,0 mm	29 mm		10
3	TD0002-24			2,4 mm 3/32"	29 mm	10N24S	10
3	TD0002-32			3,2 mm 1/8"	29 mm	10N25S	10
4	TQ0002					18CG	10
4	TQ0008 *					-	10
7	BW0056				58 mm	57Y03	10
7	BW0066				117 mm	57Y02	10
7	BW0067				22,5 mm	57Y04	10
7	EA0130						10

\* ONLY FOR 18 HC

## STUBBY GAS LENS

	CODE		Gr	Ø		REF	
1	TC0041		4	6,4 mm 1/4"	25,5 mm	53N58	10
1	TC0042		5	8 mm 5/16"	25,5 mm	53N59	10
1	TC0043		6	9,8 mm 3/8"	25,5 mm	53N60	10
1	TC0044		7	11,2 mm 7/16"	25,5 mm	53N61	10
1	TC0045		8	12,7 mm 1/2"	25,5 mm	53N61S	10
2	TE0095-16			1,6 mm 1/16"	29 mm	-	10
2	TE0095-20			2,0 mm 5/64"	29 mm	-	10
2	TE0095-24			2,4 mm 3/32"	29 mm	-	10
2	TE0095-32			3,2 mm 1/8"	29 mm	-	10
3	TD0095-16			1,6 mm 1/16"	30,7 mm	-	10
3	TD0095-20			2,0 mm 5/64"	30,7 mm	-	10
3	TD0095-24			2,4 mm 3/32"	30,7 mm	-	10
3	TD0095-32			3,2 mm 1/8"	30,7 mm	-	10
4	TQ0095					18CG20	10
4	TQ0096 *						10
7	BW0056				58 mm	57Y03	10
7	BW0066				117 mm	57Y02	10
7	BW0067				22,5 mm	57Y04	10
7	EA0130						10

\* ONLY FOR 18 HC

## STUBBY GAS LENS (Cu)

	CODE		Gr	Ø		REF	
1	TC0041		4	6,4 mm 1/4"	25,5 mm	53N58	10
1	TC0042		5	8 mm 5/16"	25,5 mm	53N59	10
1	TC0043		6	9,8 mm 3/8"	25,5 mm	53N60	10
1	TC0044		7	11,2 mm 7/16"	25,5 mm	53N61	10
1	TC0045		8	12,7 mm 1/2"	25,5 mm	53N61S	10
2	TE0096-16			1,6 mm 1/16"	30,6 mm	-	10
2	TE0096-20			2,0 mm 5/64"	30,6 mm	-	10
2	TE0096-24			2,4 mm 3/32"	30,6 mm	-	10
2	TE0096-32			3,2 mm 1/8"	30,6 mm	-	10
3	TD0096-16			1,6 mm 1/16"	33 mm	-	10
3	TD0096-20			2,0 mm 5/64"	33 mm	-	10
3	TD0096-24			2,4 mm 3/32"	33 mm	-	10
3	TD0096-32			3,2 mm 1/8"	33 mm	-	10
4	TQ0095					18CG20	10
4	TQ0096 *						10
7	BW0056				58 mm	57Y03	10
7	BW0066				117 mm	57Y02	10
7	BW0067				22,5 mm	57Y04	10
7	EA0130						10

\* ONLY FOR 18 HC

The Stubby collets allow the use of the small nozzles of the 9/20 series on the 17/18/26 torch bodies.

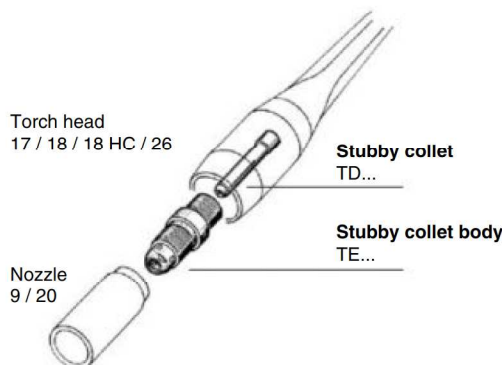

# TIG BLISTERED WEAR PARTS



CODE		DESCRIPTION	SIZE	PCS X	BOX X
BW0056P		tig cap 58 mm	17 - 18 - 26	3	10
BW0064P		back cap 53 mm	9 - 20	3	10
BW0065P		back cap 17,5 mm	9 - 20	3	10
BW0067P		back cap 22,5 mm	17 - 18 - 26	3	10
TC0003P		gr 5	17 - 18 - 26	6	10
TC0004P		gr 6	17 - 18 - 26	6	10
TC0005P		gr 7	17 - 18 - 26	6	10
TC0006P		gr 8	17 - 18 - 26	6	10
TC0007P		gr 10	17 - 18 - 26	6	10
TC0008P		gr 12	17 - 18 - 26	6	10
TC0012P		gr 4	9 - 20	6	10
TC0013P		gr 5	9 - 20	6	10
TC0014P		gr 6	9 - 20	6	10
TC0015P		gr 7	9 - 20	6	10
TC0016P		gr 8	9 - 20	6	10
TC0017P		gr 10	9 - 20	6	10
TD0001P16		Ø 1.6	17 - 18 - 26	4	10
TD0001P20		Ø 2.0	17 - 18 - 26	4	10
TD0001P24		Ø 2.4	17 - 18 - 26	4	10
TD0001P32		Ø 3.2	17 - 18 - 26	4	10
TD0001P40		Ø 4.0	17 - 18 - 26	4	10
TD0003P16		Ø 1.6	9 - 20	4	10
TD0003P20		Ø 2.0	9 - 20	4	10
TD0003P24		Ø 2.4	9 - 20	4	10
TD0003P32		Ø 3.2	9 - 20	4	10

CODE		DESCRIPTION	SIZE	PCS X	BOX X
TE0001P16		Ø 1.6	17 - 18 - 26	3	10
TE0001P20		Ø 2.0	17 - 18 - 26	3	10
TE0001P24		Ø 2.4	17 - 18 - 26	3	10
TE0001P32		Ø 3.2	17 - 18 - 26	3	10
TE0001P40		Ø 4.0	17 - 18 - 26	3	10
TE0003P16		Ø 1.6	9 - 20	3	10
TE0003P20		Ø 2.0	9 - 20	3	10
TE0003P24		Ø 2.4	9 - 20	3	10
TE0003P32		Ø 3.2	9 - 20	3	10
TQ0001P		insulator	9 - 20	3	10
TQ0002P		insulator	17 - 18 - 26	3	10

